

MODUS®



DOMUS Line®



Light from a different corner

MODUS® is a modular system composed by an aluminium profile finalized to the use of one or more LEDs. The units (available in 4 different lengths) are installable under the cabinet or inside the cabinet (i.e. kitchens, wardrobes, showcases and displays) . Can be installed in continuous row with other units thanks of its special BUS connector. Every module is supplied with closing cups that allow also to cover the screws. A special optic vain on the diffuser contains the lens of the Top Power LED. In this way the light distribution is correctly directed and the projection is without annoying shades or deflection.



Key features:

- long life (up to 50.000 operative hours with 70% of the luminous flux guaranteed)
- clean light without components IR and UV
- high safety Factor due to the low voltage feed
- very low heat dispersion (no burn risk)
- no maintenance costs
- very low Energy consumption (only 1,2W)
- instant lighting (less then 100ns)
- high performances



NEW LUXEON REBEL TOP POWER LED

All DOMUS Line®MODUS® Power LED modules are equipped with Luxeon® Rebel LEDs - the smallest surface mountable power LED available today. This revolutionary LED permits very high light flows to be reached, 30% higher than any other type of LED on the market. Another feature of Luxeon® Rebel is assembly, which is automatic with SMT machines, with a precision of 150 micron. This type of LED can be powered with currents which vary between 350mA and a maximum of 500mA, modifying in this way its power and light intensity. DOMUS Line®, by uniting technology and innovation, offers sensible standard and custom solutions designed for these types of applications. For a correct function the Power LED modules must be powered with DOMUS Line® current stabilized drivers; in this way the LED functions with a correct temperature which allows it to fully maintain its light intensity and color features over time.



NEW FR4 PCB LED STRIP

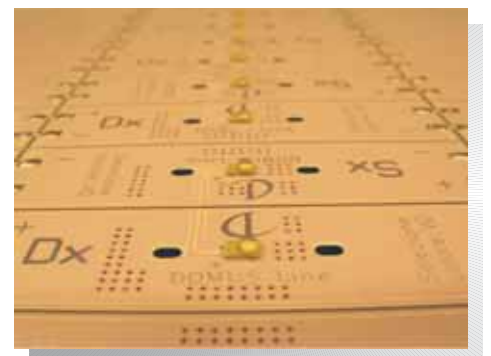

A futuristic LED technology inside a lighting device with pure and square lines in esteemed material; synthesis between design and functionality

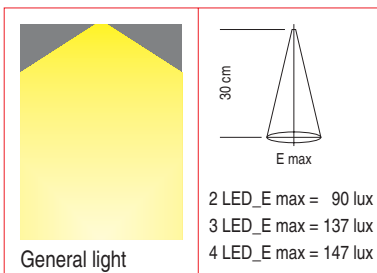

Cool white

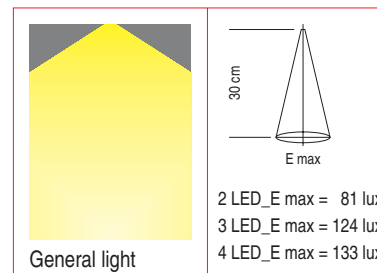

Warm white

Power: 1,2 W a 350 mA
Colour appearance: cool white
Colour temperature: 5000 - 5600 °K
Luminous flux: 109 lm

Power: 1,2 W a 350 mA
Colour appearance: warm white
Colour temperature: 2800 - 3200 °K
Luminous flux: 109 lm

Suggested for the lighting of furniture with finishes or base colours and for contrast effects (for example white, black, metallic colours such as aluminium, steel, etc.).

Suggested for the lighting of furniture with natural essences (for example oak, wenge, teak, etc.) or colours (for example red, green, yellow, etc.)

SWITCH_TT option installation

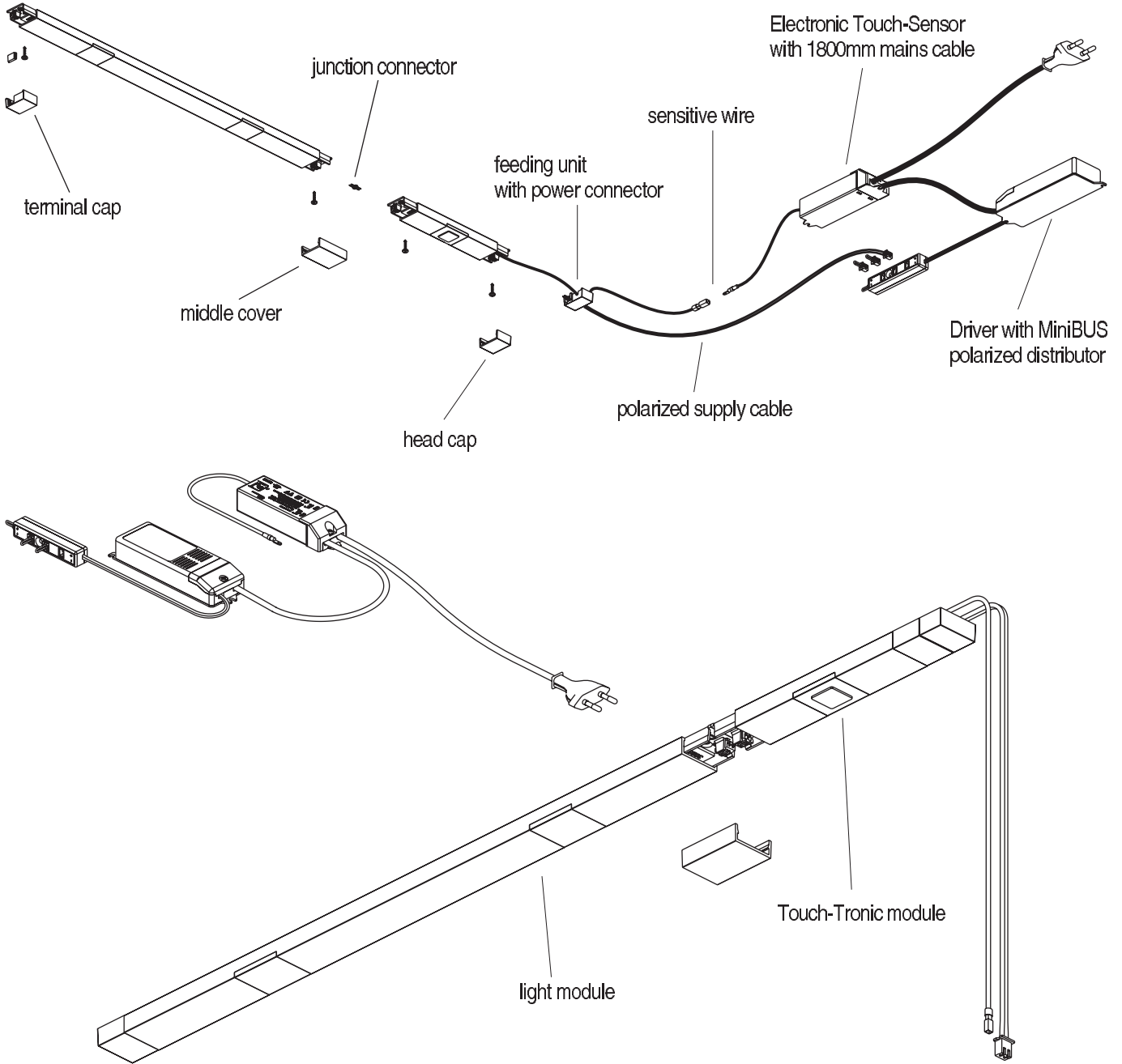

Converter CD17

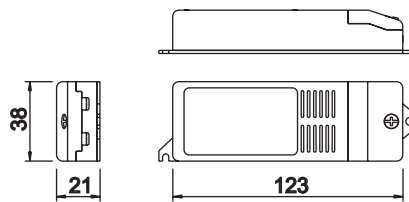

Touch-Sensor

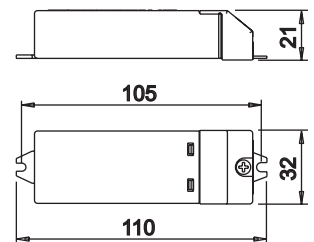

SWITCH_IFR option installation

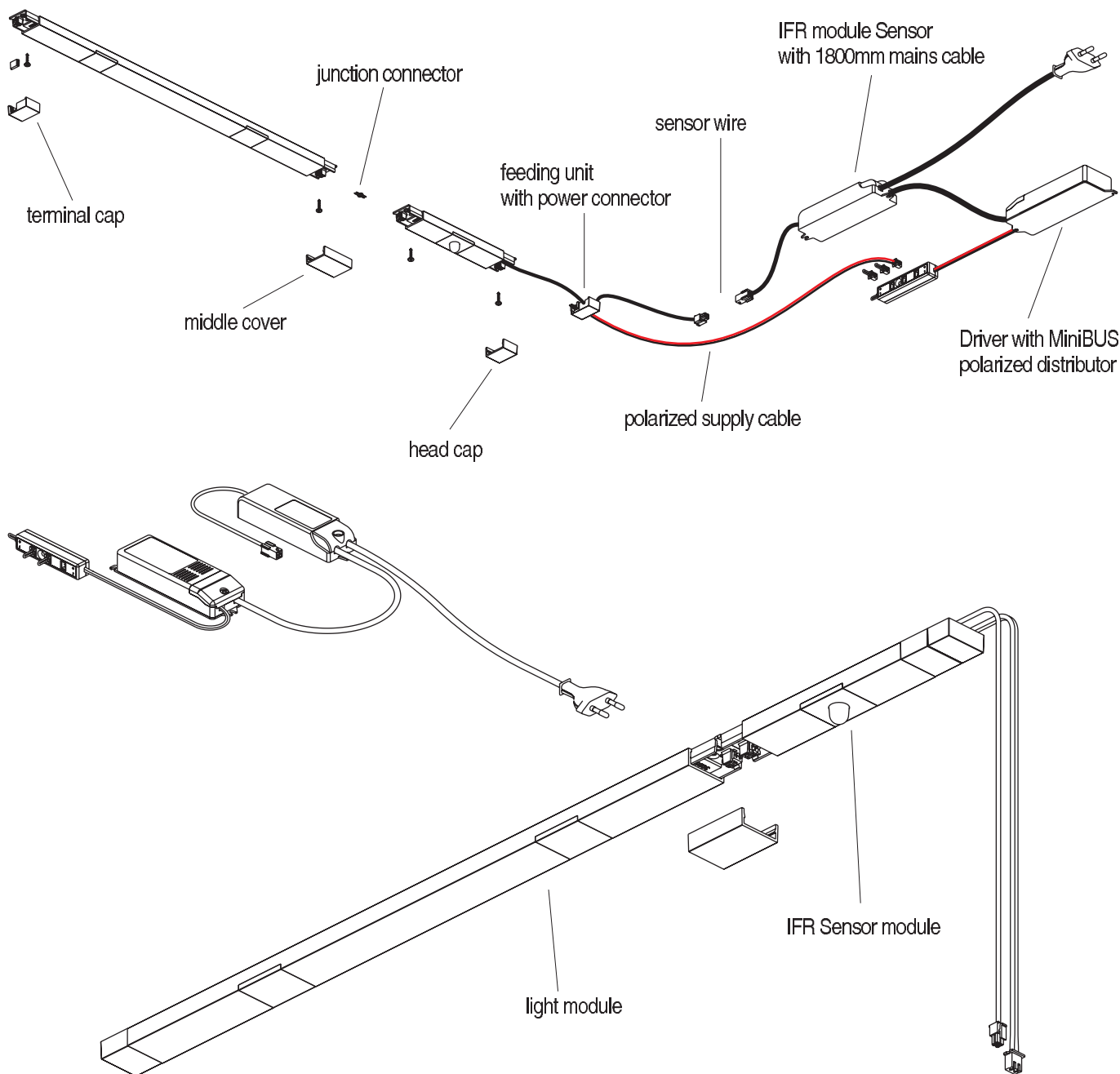

Converter CD17

IFR Sensor

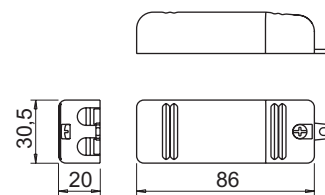
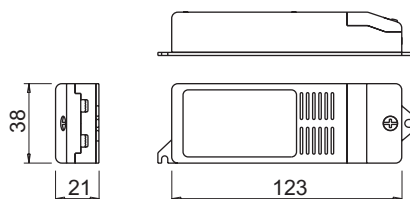

SWITCH_IR Simply option installation

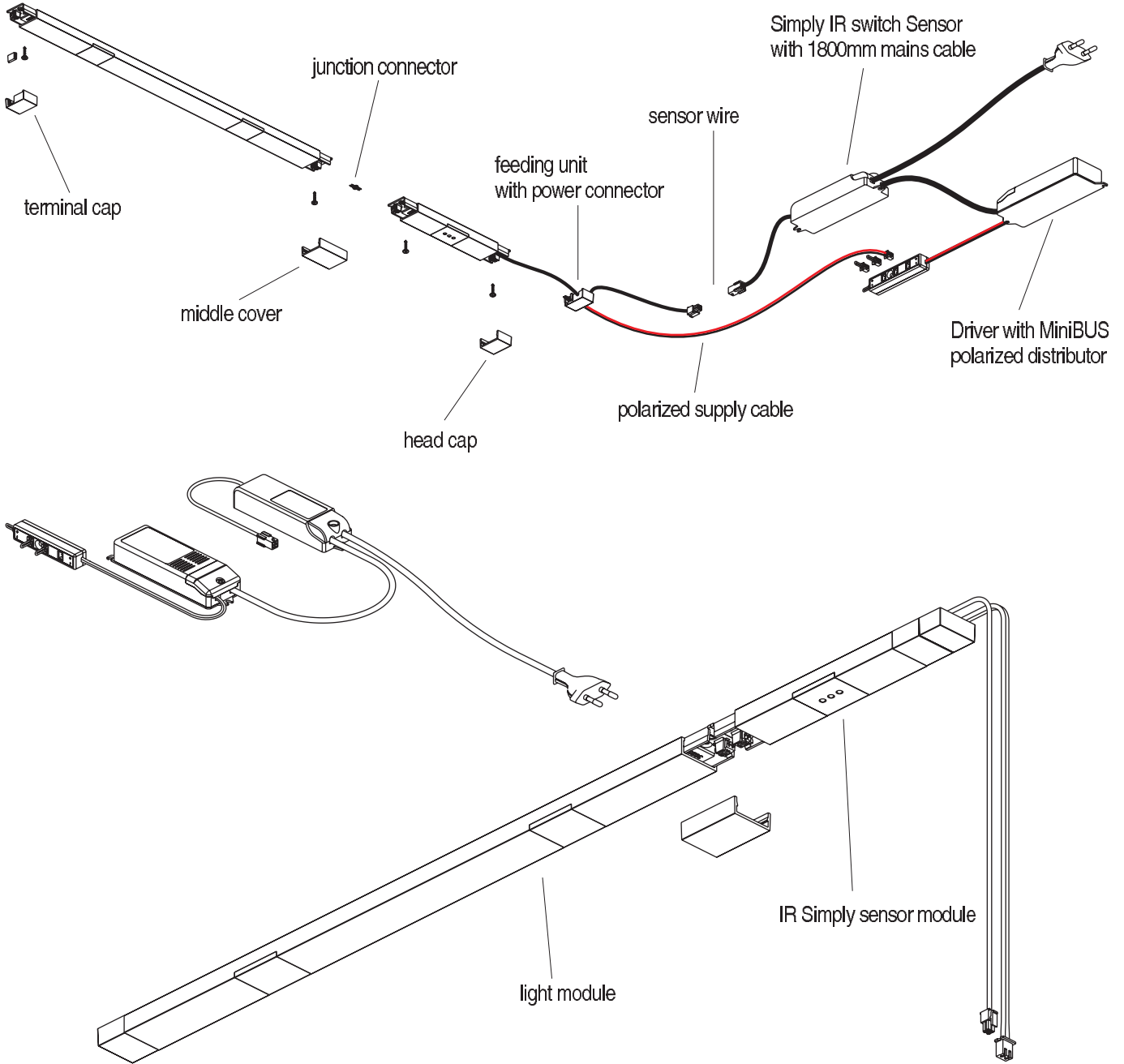

Converter CD17

IR Simply Sensor

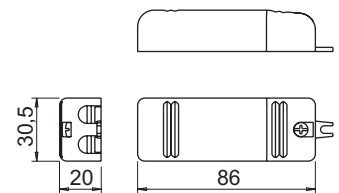
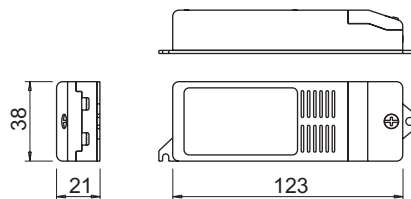

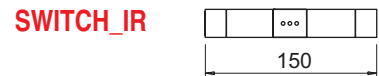
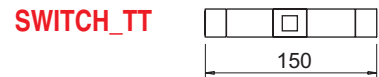
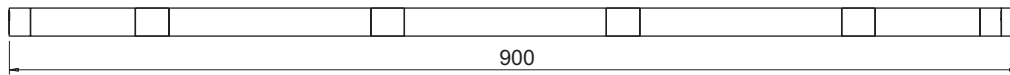
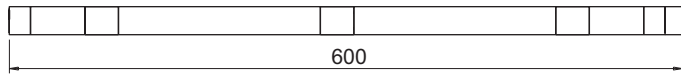
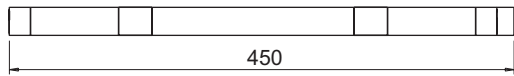
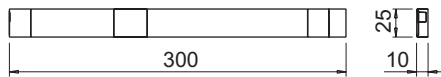

The effective lengths of the lighting unit and of **SWITCH_TT**, **SWITCH_IR** and **SWITCH_IFR** units have been developed to ensure that all the compositions (single or in continuous row) observe the standard sizes of the hanging cabinets (either undercabinet and inside cabinet). In order to offer the widest flexibility, **SWITCH_TT**, **SWITCH_IR** and **SWITCH_IFR** can be installed wherever within the composition.

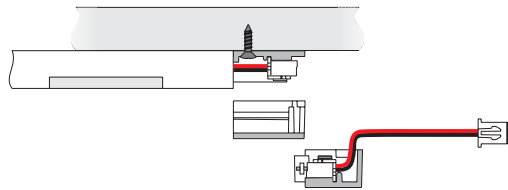

The feeding head (to order separately) is supplied with polarized cable (red/black) 2000 mm and new male BUS connector already mounted that allows a very easy, quick and safe installation without the risk to invert the polarities (that would damage the LED). For the passage of the connector it requires a hole of only 9 mm in diameter. The connection to the female sockets of the BUS System® MiniDistributor is easy, totally safe and without risk of error (non-reversible). The feeding unit has a lateral and superior flow hole that allows the exit of the cable through the installation surface or parallelly to it.

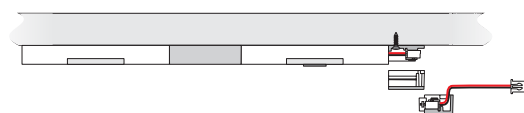

The modules **SWITCH_TT**, **SWITCH_IR** and **SWITCH_IFR** are installable on the position of the composition that you prefer and allows using the function of electronic Touch-Thronic switch (Soft-Touch), NO-Touch infrared sensor (IR-Sensor) and Movement infrared sensor (IFR) .

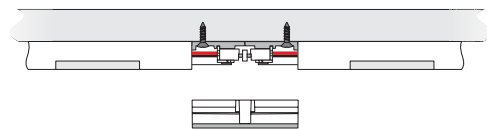

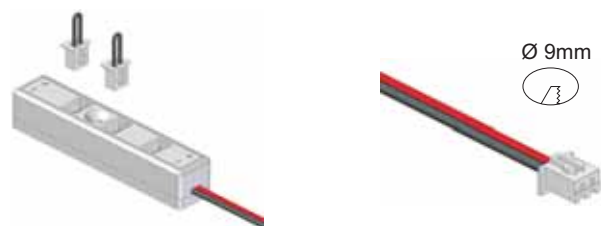
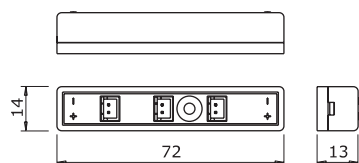

Can be installed in continuous row with other units thanks of its special connector. Every module is supplied with middle closing cups that allow also to cover the screws. Very fast fixing system with special hidden screws directly to the installation plan.

MODUS®



MODUS®						
Product Code	Finish	Lenght	Power	Current	Color appearance	T °Kelvin
1058705	aluminium	300 mm	2 X 1,2 W	350 mA	cold white	5000 - 5600
1058716A	steel	300 mm	2 X 1,2 W	350 mA	cold white	5000 - 5600
1058805	aluminium	450 mm	2 X 1,2 W	350 mA	cold white	5000 - 5600
1058816A	steel	450 mm	2 X 1,2 W	350 mA	cold white	5000 - 5600
1058905	aluminium	600 mm	3 X 1,2 W	350 mA	cold white	5000 - 5600
1058916A	steel	600 mm	3 X 1,2 W	350 mA	cold white	5000 - 5600
1059005	aluminium	900 mm	4 X 1,2 W	350 mA	cold white	5000 - 5600
1059016A	steel	900 mm	4 X 1,2 W	350 mA	cold white	5000 - 5600
1058705B	aluminium	300 mm	2 X 1,2 W	350 mA	warm white	2800 - 3200
1058716AB	steel	300 mm	2 X 1,2 W	350 mA	warm white	2800 - 3200
1058805B	aluminium	450 mm	2 X 1,2 W	350 mA	warm white	2800 - 3200
1058816AB	steel	450 mm	2 X 1,2 W	350 mA	warm white	2800 - 3200
1058905B	aluminium	600 mm	3 X 1,2 W	350 mA	warm white	2800 - 3200
1058916AB	steel	600 mm	3 X 1,2 W	350 mA	warm white	2800 - 3200
1059005B	aluminium	900 mm	4 X 1,2 W	350 mA	warm white	2800 - 3200
1059016AB	steel	900 mm	4 X 1,2 W	350 mA	warm white	2800 - 3200
1059105B	aluminium	150 mm	SWITCH_TT Soft Touch module			
1059116AB	steel	150 mm	SWITCH_TT Soft Touch module			
1060005	aluminium	150 mm	SWITCH_IR Sensor NO-Touch module			
1060016A	steel	150 mm	SWITCH_IR Sensor NO-Touch module			
1059105	aluminium	110 mm	SWITCH_IFR Sensor Movement detector module			
1059116A	steel	110 mm	SWITCH_IFR Sensor Movement detector module			
1133910	aluminium	2000 mm connecting cable with male BUS connector				
1133930	steel	2000 mm connecting cable with male BUS connector				

Converter						
Product Code	Type	Input	Frequency	Output	Application	Approved
0833801	NANO	220-240 Vac	50-60Hz	350 mA	max 4 LED	CE
0832801	CD10	220-240 Vac	50-60Hz	350 mA	max 6 LED	CE
0834101	CD17	220-240 Vac	50-60Hz	350 mA	max 12 LED	CE
0832901	DPL500	220-240 Vac	50-60Hz	500 mA	max 6 LED	CE 
0832801C	CD10UL	95-120 Vac	50-60Hz	350 mA	max 6 LED	 us
1132301	BUS6+	BUS distributor addendum				

